

Self Clinch Miniature Nuts Installation Guide

1

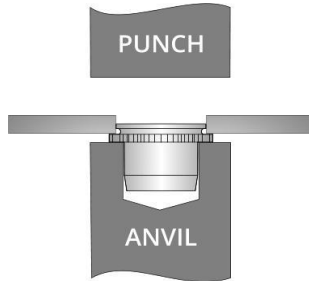

Drill Or Punch Correct Hole size
Do Not De-burr OR Chamfer.
Place The Fastener In To The Anvil
With The Shank Facing Up Like In
The Above Diagram.

2

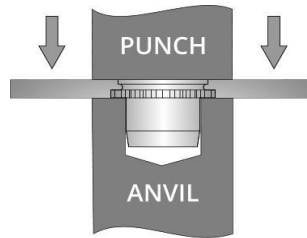

Locate The Panel Mounting
Hole Over The Shank Ensuring
The Panel Is Held Level
With The Punch And Anvil Surfaces Level
Apply A Squeezing Force Until The Knurled
Collar Is Flush With The Top Of The Panel
OR The Shank Is Flush With The Bottom
Panel In Thinner Panels.
Do Not Over Squeeze.

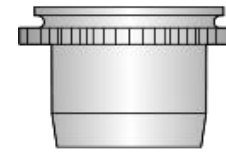

Anvil

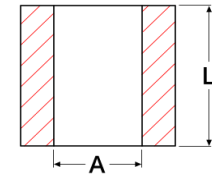

Anvil Dimensions		
Thread Sizes	A +0.12	L Min.
M2	2.63	2.30
M3	4.09	2.55
M4	5.36	3.20
M5	6.61	3.70
M6	7.85	3.95

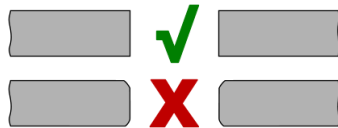

Do Not Remove Burr Or Chamfer
The Hole As This Could Result In
Improper Installation Or Reduced
Performance

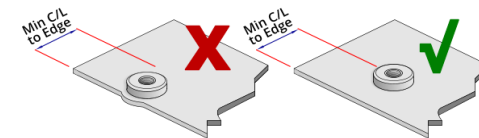

Ensure That Attention Is Paid To The Minimum Hole Centreline To Edge
Dimension For Each Fastener. Installing Too Close To An Edge Or Bend
Could Result In Improper Installation Or Reduced Performance.
Minimum Centreline To Edge Dimensions Shows Each Fastener And
Applies To One Edge Only. If This Distance Is Applied On Multiple Sides
There Will Be Significant Panel Distortion Unless The Panel Edges Are